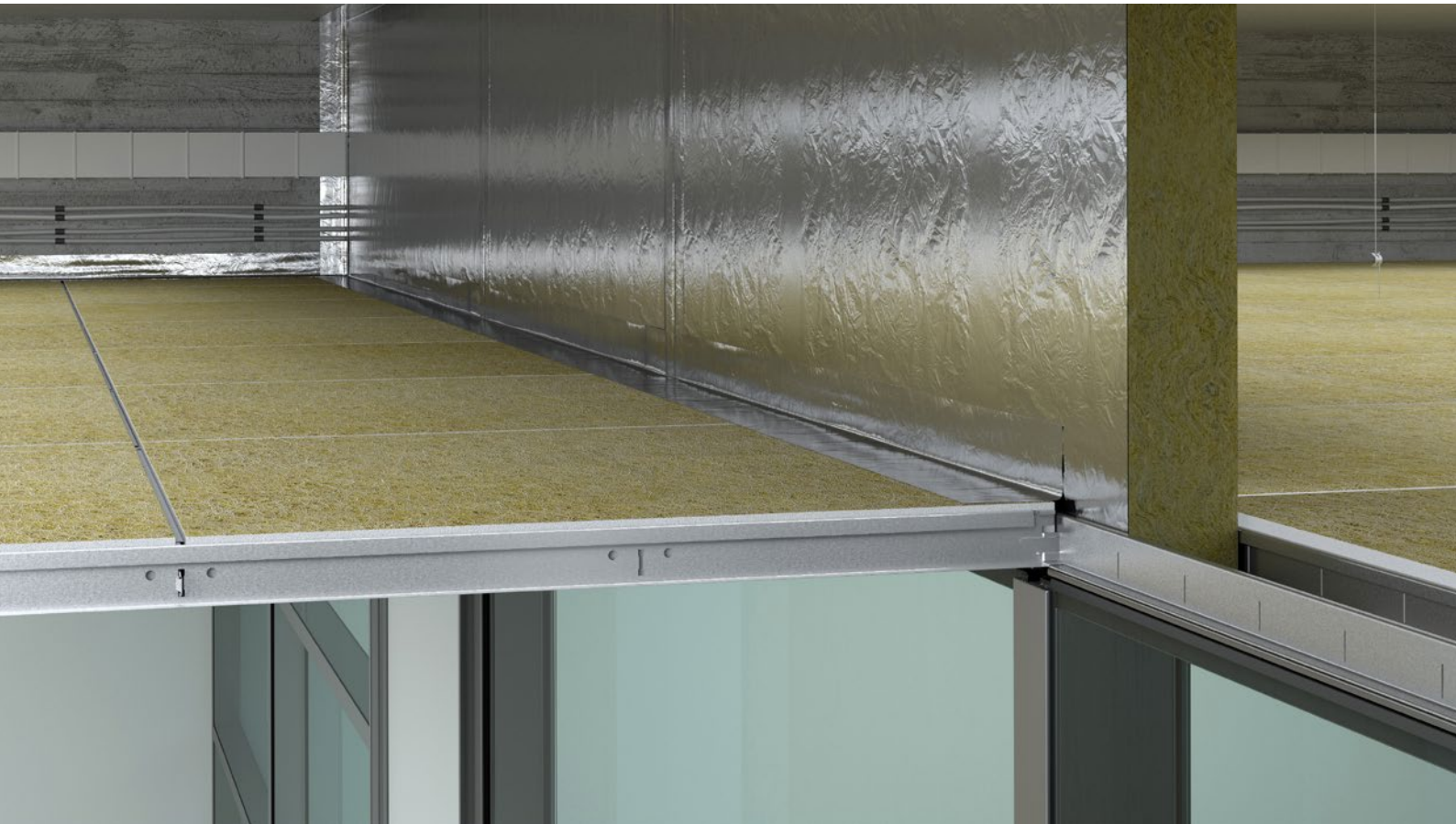

PRODUCT SUSTAINABILITY DECLARATION

Rockfon® Acoustimass™**Our sustainable commitment**

Sustainability sits at the heart of our research and development. It's why we use natural stone, constantly reduce our carbon footprint and recycle as part of circular economy.

Our noise absorbing ceiling and wall systems are a fast and simple way to create beautiful, comfortable spaces. Easy to install and durable, they protect people from noise and the spread of fire while making a constructive contribution toward a sustainable future.

Content

In this declaration you will find product specific information on the following:

1. Contribution to the major building rating schemes
2. Our approach to responsible sourcing of raw materials
3. Recycled content
4. Recycling of product in the end of life
5. Where you can find our third-party verified EPD
6. Health and safety of stone wool fibers
7. Compliance with REACH
8. Our corporate sustainability reporting from ROCKWOOL Group
9. Availability of indoor low emission labels
10. Availability of ISO certificates for manufacturing
11. Information on material content

Contribution to building rating schemes

LEED® version 4.1

Integrative Process (IP)	Max credits
- Integrative process	1 point
Materials and resources (MR)	Max credits
- Building Life-Cycle Impact Reduction	1 point
- Building product disclosure and optimization	
- Environmental Product Declarations	1 point
- Building product disclosure and optimization	
- Sourcing of Raw Materials	2 points
- Building product disclosure and optimization	
- Material Ingredients	2 points
- Construction and Demolition Waste Management	2 points
Indoor Environmental Quality (EQ)	Max credits
- Low-emitting materials	3 points
- Indoor Air Quality assessment	2 points
- Interior lighting	1 point
- Acoustic performance	1 point
Innovation (IN)	Max credits
- Innovation	5 points

WELL Building Standard™ version 2

Air Concept	Max credits
- A01: Air Quality	n/a - Precondition
- A04: Construction pollution management	n/a - Precondition
- A05: Enhanced Air Quality	1 point
Water Concept	Max credits
- W07: Moisture Management	1 point
Light Concept	Max credits
- L01: Light Exposure (indirect)	n/a – Precondition
- L02: Visual Lighting Design (indirect)	n/a – Precondition
- L06: Daylight Simulation (indirect)	2 points
- L07: Visual Balance (indirect)	1 point
Thermal Comfort	Max credits
- T01: Thermal Performance	n/a – Precondition
- T07: Humidity Control	1 point
Sound Concept	Max credits
- S02: Maximum Noise Levels	3 points
- S03: Sound Barriers	3 points
- S04: Reverberation Time	2 points
- S05: Sound Reducing Surfaces	2 points
- S06: Minimum Background Sound	1 point
Material Concept	Max credits
- X01 Material Restrictions	n/a – Precondition
- X05 Enhanced Material Restrictions	1 point
- X06 VOC Restrictions	2 points
- X08 Materials Optimization	2 points
Mind Concept	Max credits
- M02 Nature and Space	n/a – Precondition
- M07 Restorative Spaces	1 point
Innovation Concept	Max credits
- I01 Innovate WELL max	10 points

BREEAM® International (New Construction 2016)

Management	Max credits
- MAN 02: Life cycle cost and service life planning	1 credit
Health and Well-Being (HEA)	Max credits
- HEA 01: Visual Comfort	4 credits
- HEA 02: Indoor Air Quality	1 credit
- HEA 04: Thermal Comfort	2 credits
- HEA 05: Acoustic Performance	4 credits
Materials (MAT)	Max credits
- Mat 01: Life cycle impacts	1 credit
- Mat 03: Responsible sourcing of construction products	4 credits
- Mat 06: Material efficiency	1 credit
Waste (WST)	Max credits
- WST 01: Construction waste management	3 credits
- WST 06: Functional adaptability	1 credit
Innovation (INN)	Max credits
- INN 01: Innovation	10 credits

DGNB 2020 INTERNATIONAL – New Buildings

Environmental Quality (ENV)	Max credits
- ENV 1.1: Building Life Cycle Assessment	9.5%
- ENV 1.2: Local environmental impact	4.7%
- ENV 1.3: Sustainable resource extraction	2.4%
Economic Quality (ECO)	Max credits
- ECO 1.1: Building Related Costs	12.9%
- ECO 2.1: Flexibility and adaptability	9.6%
Sociocultural and functional quality (SOC)	Max credits
- SOC 1.1: Thermal comfort	4.5%
- SOC 1.2: Indoor air quality	5.4%
- SOC 1.3: Acoustic comfort	2.9%
- SOC 1.4: Visual comfort	3.4%
- SOC 1.6: Quality of indoor and outdoor spaces	5.4%
Technical Quality (TEC)	Max credits
- TEC 1.1: Fire safety	2.9%
- TEC 1.2: Sound insulation	2.3%
- TEC 1.5: Ease of cleaning building components	1.8%
- TEC 1.6: Ease of recovery and recycling	3.5%
Process Quality (PRO)	Max credits
- PRO 1.5: Documentation for sustainable management	1.1%
- PRO 2.1: Construction site / construction process	1.6%

The points or credits gained in each scheme are not solely dependent upon the performance of Rockfon products. Rockfon products merely help towards the goal of achieving the credits or points but they are not a stand alone element. The final credits earned depend on various elements, components and overall building performance. Rockfon shall not guarantee or be held liable for non-fulfilment of the credits which can include a broader assessment of construction products and building elements. The credits or points in each scheme are the result of internal evaluation.



Life cycle and environmental certifications

Sourcing of raw materials

Recycled content

The recycled content of the mineral wool core in Rockfon products is >40%. Including facings (paint and glass fleeces) the recycled content of the full product is between 29% and 64% according to ISO 14021.

The recycled content is primarily post-industrial/pre-consumer resulting from upcycling waste from other industries, that would otherwise be sent to landfill. Wool waste from end of life recycling, installation cut-offs and manufacturing (e.g. as part of briquettes) is also included.

The information provided under recycled content is self-declared.

Responsible sourcing

>90% of all suppliers identified as key suppliers to the ROCKWOOL Group have currently signed the ROCKWOOL Code of Conduct for Suppliers.

The ROCKWOOL Code of Conduct addresses laws and standards compliance, equal opportunities, trade union recognition, fair employment, safe and healthy working conditions, no child labour, sound environmental principles, purchasing ethics and bribery.

Environmental Product Declarations and Carbon Footprint

Our EPD covers our full portfolio and it is third party verified according to EN 15804. It is available in our website and also in external databases, like IBU (Institut Bauen und Umwelt), EPD Norge, INIES and UL. In order to get product specific information, please use the product scaling formula in the EPD or get in touch with our local support team.

The carbon footprint (kg of CO₂ eq.) of the product, from cradle to gate is given in this declaration in the Performance section below. The carbon footprint value derives from the third party verified Rockfon EPD with the application of the product scaling formula and the impact of the facing.

Cradle to Cradle Certified®

Rockfon acoustic solutions are Cradle to Cradle Certified® Silver and Bronze. The certification covers most of the products in our portfolio. Cradle to Cradle Certified® Product Standard is a globally recognized measure to create safer, more sustainable products made for circular economy.

** According to the information provided by such third party manufacturers, who have been carefully selected by Rockfon, the products delivered by said third party suppliers fulfil the content requirements stated in the above schemes. Rockfon however accepts no liability should such information provided prove to be incorrect.*



Product health

Low emitting materials

This product is certified for low emissions. Laboratories employed by Rockfon are accredited under ISO/IEC 17025 for the applied test methods. Please consult the table in the final page to see which low emission labels are available for the product.

Safe raw materials

Material ingredients

Rockfon materials are regularly screened against BREEAM Norway A20 list and the REACH candidate list; biocides/pesticide, flame retardants, azo dyes, nitrosamines and aromatic amines, halogenated compounds, nanomaterials, plastic softeners, surfactants and classified substances, among others, by an independent third party (Alttox Ltd).

Rockfon products comply with the Authorization List – Annex XIV, the Restriction list – Annex XVII and the SVHC candidate list, (June 2013). No substances listed in Annex XIV and Annex XVII of REACH regulation* are intentionally added to the products included in this declaration". Rockfon ceiling tiles do not contain substances of very high concern (SVHC) in concentrations >0.01% (100 ppm).

The general cut off concentrations is 1000 ppm for external raw material suppliers. But for the stone wool core material the inventory threshold is 100 ppm (0.01%).

Health and fibres

The Rockfon stone wool fibers are a non-hazardous material to work with. This fact is supported by the decision of the World Health Organisation's International Agency for Research on Cancer (IARC) to exempt stone wool from its list of "possibly cancer causing agents". Rockfon stone wool core is certified to comply with the Note Q for safe mineral wool fibres of EU Regulations (EC) No 1272/2008 and Directive 97/69/EEC and has a certificate from EUCEB (European Certification Board for Mineral Wool Products).



Corporate sustainability reporting

Sustainability reporting

ROCKWOOL Group is a participant in the UN Global Compact. SDG Invest includes ROCKWOOL Group in a portfolio of the 60 best performing companies globally. The ROCKWOOL Group Sustainability report covers the calendar year and is informed by the Global Reporting Initiative (GRI) Standards. The Group performance on CO₂ emissions is regularly disclosed through international reporting platforms such as the Carbon Disclosure Project (CDP). Our Environmental Health & Safety performance was rated 'Prime' – the highest rating score – by leading sustainable investment rating agency ISS-oekom.

The report is available for download on www.rockwoolgroup.com/sustainability

Material ingredients table

Substances	E.C. Number ¹⁾	Amount weight (%)	REACH Regulation	REACH substances registration number	Function
Stone wool	926-099-9	73-97%	Not classified	01-211-947-2313-44	Core insulation material
Binder, a thermoset inert polymer resin	Proprietary composition	<4%	Not classified	No number	Structural binder
Mineral oil	Proprietary composition	<0,2%	Not classified	No number	Water repellent
Non-woven glass wool facing	Proprietary composition	1-15%	Not classified	No number	Facing
Water based paints	Proprietary composition	0-16%	Not classified	No number	Decorative finish
Glue	Proprietary composition	0,01	Not classified	No number	Glue

¹⁾ E.C.: EC-no, determined by the European Commission for identifying materials

Performance



Reaction to fire
A2-s1,d0



Humidity and sag resistance
Up to 100% RH



Environment
Fully recyclable stone wool
The recycled content of Rockfon products is between 29% and 64% according to ISO 14021.



Hygiene
Stone wool provides no sustenance to microorganisms



Carbon footprint
Cradle-to-Gate 6.48 kg of CO₂ eq. (based on third party verified EPD)
Cradle-to-Grave 8.79 kg of CO₂ eq. (based on third party verified EPD)

Product summary table

The following table is categorised by edge type and provides all relevant information related to the products sustainability profile.

	Module size (mm)	Recycled content	Environmental & emission labels							Management systems certifications		Fibre chemistry	Substance Screening	
			E1*	Cradle to Cradle	Blue Angel (RAL DE-UZ 132)	Danish Indoor Climate Label	M1	Singapore Green Building Council	Singapore Green Label	ISO 14001	ISO 9001	EC Note Q compliance (EUCEB)	REACH compliance	BREEM NO A20 list
	1200 x 600 x 80	-	✓	-	-	✓	-	-	-	✓	✓	✓	✓	✓
	1200 x 1000 x 80	-	✓	-	-	✓	-	-	-	✓	✓	✓	✓	✓

* 124 microgram/m³ according to test method EN717-1, based on loading scenario 1 m²/m³, after 14 days (23+/-0,5 °C, RH 45+/-3%.)

11.2022 | This document is valid 3 years from date created.
 All colour codes mentioned are based on the NCS - Natural Colour System® property of and used on licence from NCS Colour AB, Stockholm 2017.
 Subject to alterations in range and product technology without prior notice.
 Rockfon accepts no responsibility for printing errors.
 Rockfon® is a registered trademark of the ROCKWOOL Group.
 Please ensure that you are using the product sustainability declaration relevant for your country/region. Our products and solutions are available across a number of countries and our website features product information and product downloads that may vary from country to country. Product range, product data

and product documentation found on a country-specific website is intended for use ONLY in that particular country unless otherwise explicitly stated so. This document may include technical inaccuracies or typographical errors. In no event shall ROCKWOOL International A/S be liable for any direct, indirect or consequential damages or any other damages whatsoever resulting from loss of use, data or profits, whether in an action of contract, negligence or other action, arising out of or in connection with the use of information available from this document.
 COPYRIGHT NOTICE. Copyright © ROCKWOOL International A/S, Hovedgaden 584, 2640 Hedehusene, Denmark. All rights reserved.

Sounds Beautiful

